

Advantage DLX

AdvantageDLX START-UP GUIDE



Overview:

Please read through Start-Up guide prior to beginning installation. Refer to the **User's Guide** located on the Companion CD for in depth details on setting up and using the Advantage DLX printer.

Package Contents:

- (1) Advantage DLX Printer
- (1) Power Supply
- (1) Power Cord
- (1) Serial, Parallel, or USB data cable
- (1) Cognitive Companion CD
- (1) Start-Up Guide (this document)

Helpful Web Links and Contact Information:

<http://www.cognitive.com>

To learn more about Cognitive approved media please contact your local reseller or Cognitive.

Direct: **+1.303.273.1400**

Toll Free: **+1.800.525.2785**

For Technical Support, please contact your local reseller or Cognitive Toll Free: **1+888.632.8292** or via Email: **Support@cognitive.com**

Cognitive

4403 Table Mountain Drive, Suite A
Golden, CO 80403

Tel: +1 303 273 1400 **Toll free:** +1 800 525 2785 **Email:** sales@cognitive.com **Web:** www.cognitive.com

Connecting Power, Loading Media, Installing Software

Follow these Steps To Set Up the Advantage DLX Printer:

Connecting Power to the Advantage DLX



Printer Power Test



- 1 Press the Power Switch to the ON position.

Note: The Power Light will turn green to indicate the unit is receiving power. The Ready Light will first turn red, then green.

- 2 Press the Power Switch to OFF before proceeding to the next steps.

Connecting Data Cable

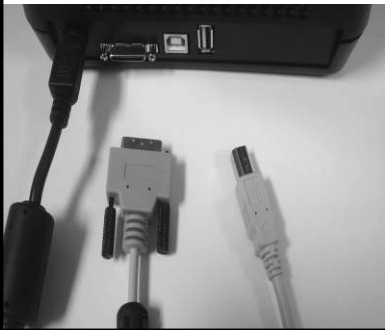

- 1 Connect USB, Serial, Parallel or Ethernet Cable to the back of the printer.

- 2 Connect opposite end of data cable to computer.

Note: Ethernet model not pictured

Installing Cognitive Administrator and Printer Driver

- 1 Insert the **Companion CD** included with the Advantage DLX printer into the computer's CD ROM drive.

- 2 Select **Install Printer** to begin installation of Windows® driver and Cognitive Administrator

Note: For more detailed information on installing drivers and configuring your printer using Cognitive Administrator, please refer to the Advantage DLX Users Guide located on the Cognitive Companion CD ROM.

Loading Media and Ribbon

Loading Media

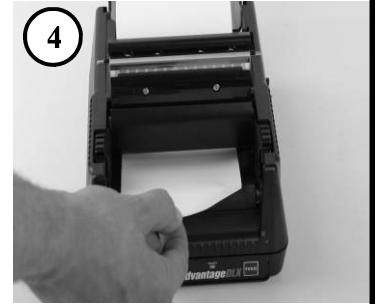

- For thermal transfer printers proceed to the loading ribbon section of this Start-Up Guide.
- For direct thermal printers go to the Self-Testing section in this Start-Up Guide.

Loading Ribbon

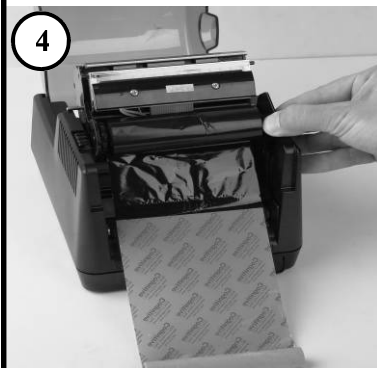
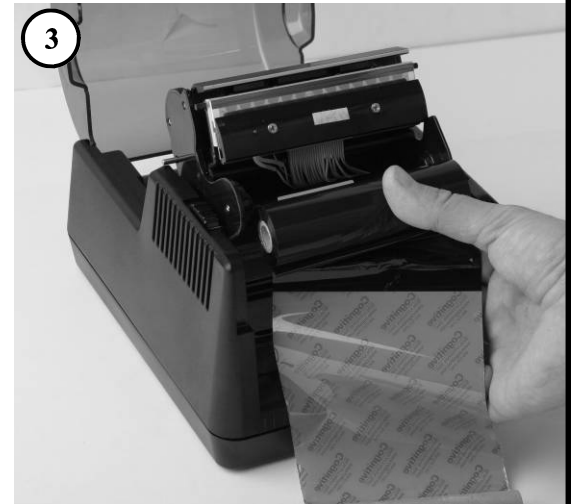

NOTE: the ribbon text on the leader should be face down in front of the printer as shown.



Self-Testing and Maintenance

Self-Testing: The self test checks the printer's overall operability and lists the printer's current settings.

IMPORTANT! The printer should have media installed, be connected to AC power, and turned off before printing.

- 1 Turn the printer ON while holding the FEED button.
- 2 Release the FEED button when the self test starts to print.
- 3 Turn the printer OFF and then ON again to return to normal printing operation.



Cleaning & Maintenance



- 1 Open the print mechanism. Turn the printer off when cleaning the printhead. Make sure the printhead is completely dry before turning the printer back on.
- 2 Clean the platen (A) and printhead (B) with a soft, lint-free cloth saturated with 99 percent isopropyl alcohol or a certified cleaning pen or card.
- 3 Turn the printer on and press the FEED button

Advantage DLX Cleaning Supplies

Part #	Size (inches)	Items per box	Description
14-00-0000	2.5" x 6"	25	Cleaning card
14-00-0001	4.5" x 6"	25	Cleaning card
14-00-0002	none	12	Cleaning pen

CAUTION! INCORRECTLY CLEANING THE PRINTER WILL CAUSE PERMANENT DAMAGE AND VOID THE PRINTER'S WARRANTY. COGNITIVE RECOMMENDS USING A CERTIFIED CLEANING PEN OR CARD FOR ALL THE PRINTER'S CLEANING REQUIREMENTS.

WARNING—SHOCK HAZARD AND STATIC DISCHARGE:

Never operate the printer in a location where it can get wet. Personal injury could result. The discharge of electrostatic energy that accumulates on the surface of the human body or other surfaces can damage or destroy the printhead or electronic components used in this device. DO NOT TOUCH the printhead or the electronic components under the printhead carriage.

CAUTION—PRINTER SETUP AND HANDLING

When installing or modifying the printer setup or configuration, ALWAYS TURN THE POWER OFF before: (1) connecting any cables, (2) performing any cleaning or maintenance operations, or (3) moving the printer.

EUROPEAN COMPLIANCE:

This is a Class A product. In a domestic environment this product may cause radio interference in which case the user may be required to take adequate measures. RoHS COMPLIANCE: Directive 2002/95/EC on the Restriction of the Use of certain Hazardous Substances in Electrical and Electronic Equipment (RoHS).

FCC DECLARATION OF CONFORMITY:

This equipment has been tested and found to comply with the limits for a Class A digital device, pursuant to Part 15 of the FCC rules. These limits are designed to provide reasonable protection against harmful interference when the equipment is operated in a commercial environment. This equipment generates, uses, and can radiate radio frequency energy and, if not installed and used in accordance with the instruction manual, may cause harmful interference to radio communications. Operation of this equipment in a residential area is likely to cause harmful interference in which case the user will be required to correct the interference at the user's own expense.

WEEE:

Directive 2002/96/EC on Waste Electrical and Electronic Equipment (WEEE). For WEEE recycling and recovery information, refer to the Cognitive web site.

INDUSTRY CANADA NOTICE:

This Class A digital apparatus complies with Canadian ICS-003 requirements.
Cet appareil numérique de la Classe A est conforme à la norme NMB-003 du Canada.

Copyright © 2006 Cognitive. Cognitive™ and Advantage DLX™ are trademarks of Cognitive. Other products and corporate names used in this publication may be trademarks or registered trademarks of other companies and are used only for explanation and to their owner's benefit, without intent to infringe. No part of this guide may be reproduced for any purpose or in any form including electronic storage and retrieval without the express permission of Cognitive.